

LoRaModCon2

Short instruction manual

Read these short instructions and the complete operating instructions before installation and keep them in a safe place.

The warranty is void if damage is caused by failure to follow the instructions.

For consequential damage, resulting from this, we accept no liability.



Safety instructions

Read the instructions in the manual.

The safety of this product is only guaranteed when it is used in accordance with its purpose.

Maintenance should only be carried out by qualified persons.

Do not install the equipment close to a heat source or in damp conditions.

Do not open the product as there is a risk of electrical shock.

For your own safety, you must ensure that the equipment is switched off before carrying out any work on it.

For your own safety, the power supply circuit must be SELV (Safety Extra Low Voltage) and must be from limited power sources.

The product must be equipped with a switching mechanism so that the power can be cut. This must be close to the product.

All electrical connections of the product must be equipped with a protective device against overload and short-circuit protection.

RECOMMENDATIONS REGARDING USE

- Before using the system, check that the power supply voltage shown in the user manual corresponds to your supply. If it doesn't, please consult your supplier.
- The device must be installed in a dry location that is sufficiently ventilated so that there is no risk of internal heating and it must not be covered with objects such as newspapers, cloths, curtains, etc.
- The device's aerial is close to the front side. It must be free and at least 10 cm away from any conducting material.
- The device must never be exposed to heat sources such as heating equipment.
- Do not install the device close to objects with naked flames such as lit candles, blowtorches, etc.
- The device must not be exposed to harsh chemical agents or solvents likely to damage the plastic or corrode the metal parts.

Note: There are additional inscriptions on the label on the housing.

Subject to technical changes and errors

Disposal instructions for packaging

Packaging and packaging aids are recyclable and should always be recycled. Please separate the packaging in accordance with local regulations.

Information about environmental protection

If one day this device becomes obsolete, you should not simply throw it into the trash. There is probably a recycling center in your community that sells old devices accepted and recycled.



The device is labelled with the CE mark and therefore complies with the essential requirements of the European Directives 2014/30/EU, electromagnetic compatibility and 2014/35/EU, electrical safety; as well as the European Radio Equipment Directive 2014/53/EU; and the Ecodesign Directive 2009/125/EC; as well as 2011/65/EU on the restriction of the use of certain hazardous substances in electrical and electronic equipment.

Mounting on top-hat rail

Important note:

Only ever apply pressure to the green housing.

Never press on the black LED-window with the imprint.

Hook the device onto the top of the top-hat rail and press it down against the top-hat rail until the locking hook engages.

To remove, unlock the hook on the underside with a screwdriver.

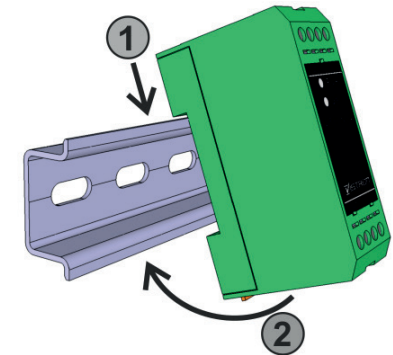

Connection diagram

